

Pearlised Soap Coconut Scented



When dosing concentrate chemicals always use the recommended PPE, and always read the labels to check best practice for handling both the undiluted & ready to use solutions.

Product Usage Guide

Professional

BK139-5



Instructions for use:



- 1 Use pelican pump to dispense into a smaller bottle or dispenser.
- 2 Remove any jewellery and then wet hands.
- 3 Apply a small amount into your wet cupped hands.
- 4 Rub hands to produce a lather.
- 5 Palm to palm.

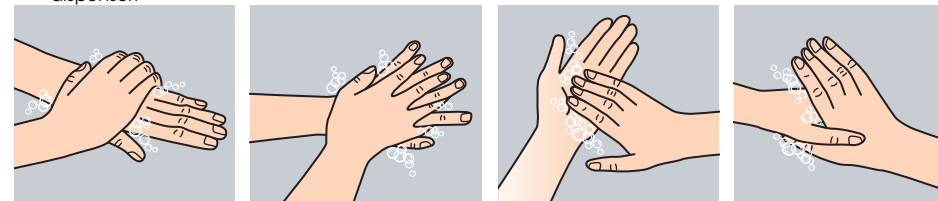

- 6 Right palm over the back of the left hand and vice versa.
- 7 Intertwine the fingers of the right hand over the left and vice versa. Pay particular attention to the areas between fingers and finger nails.
- 8 Rotationally rub backwards and forwards with clasped fingers of the right hand in the left palm. Change hands and repeat.
- 9 Rotationally rub the right thumb clasped in the left palm, change hands and repeat.

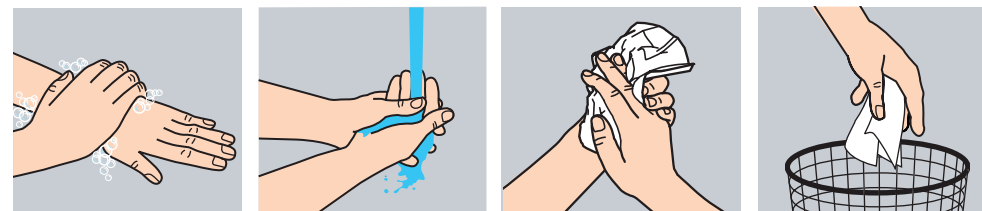

- 10 Grip the left wrist and work cleanser into the skin. Do the same with the right wrist.
- 11 Rinse off all traces of soap with clean water.
- 12 Dry hands thoroughly with a disposable paper towel.
- 13 Discard paper towel in waste bin, avoid touching the bin.

Areas for use



Scan for further product details

Health & Safety

Please refer to relevant COSHH Safety Data Sheet



Avoid contact with eyes.
If contact occurs, rinse immediately with clean water.



www.jangro.net