

Lime Disinfectant



When dosing concentrate chemicals always use the recommended PPE, and always read the labels to check best practice for handling both the undiluted & ready to use solutions.

Product Usage Guide

Professional



BC021-5



General Disinfection:



1 Use appropriate PPE as indicated in the Safety Data Sheet.

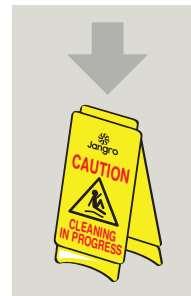

2 Place Safety Signs.



3 Dilute 160ml to 5 litres of clean water (1:30).

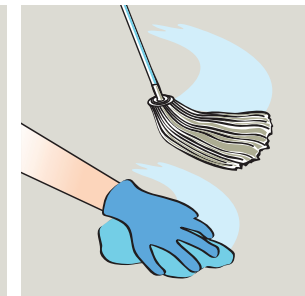

4 Mop or wipe surface.



5 Remove Safety Signs.

Routine Cleaning & odourising of Floors, walls & painted surfaces:



1 Use appropriate PPE as indicated in the Safety Data Sheet.

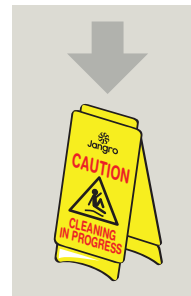

2 Place Safety Signs.



3 Dilute 80ml to 5 litres of clean water (1:60).

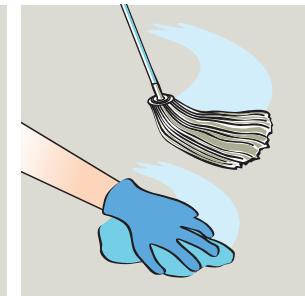

4 Mop or wipe surface.



5 Remove Safety Signs.

Areas for use



Scan for further product details

Health & Safety

Please refer to relevant COSHH Safety Data Sheet



Use neat for sinks, drains and gulleys.



www.jangro.net